

GDLM-A004R3D9IP

Key Features:

High Reliability
 Compactable size
 Auto Power Control
 Low Power Consumption
 Wide Operating Temperature

Applications:

Rotary Laser Levels
 Surveying Equipment
 Laser Alignment & Pointing

Model Number		GDLM-A004R3D9IP			
Optical Parameters		Specs			Conditions
		Min	Typ	Max	
Wavelength		531nm	532nm	533nm	
Output Power		4.2mW	4.5mW	4.8mW	@25 °C
Power Stability	2hours @ Constant Temp	-	-	+/-5%	APC
	Over Operating Temp Range	3mW	-	4.8mW	
Operating Temperature (Case)		-	0~+40 °C	-	APC
Residual IR		-	-	1%	
Beam Diameter		-	-	21mm	@30m
Beam Divergence		-	-	0.7mrad	Full angle
Roundness		70%	80%	100%	
Warm Up Time		-	1s	-	0~40 °C
Electrical Parameters					
LD Working Current		-	265mA ^①	400mA	
LD Working Voltage		1.6V	1.9V	2.2V	
Monitor Current		5uA	-	110uA	
GDL Power Consumption		-	0.53W ^②	0.88W	
Mechanical Parameters					
Laser Head Dimensions	Length	43.9mm	44.2mm	44.5mm	
	Diameter	11.85mm	11.9mm	11.95mm	
Beam Alignment Tolerance	Position(Δr)	-	0.3mm	0.5mm	
	Angle	-	7mrad	17.5mrad	
Reliability					
Storage Temperature		-20 to +60 °C			
Shock		1000g, 1ms, 6 shocks, 3 axes, 2 shocks/axis			
Vibration		20~2000Hz, 0.02g ² /Hz, 3 axes, 1hr/axis			
Expected Lifetime (MTTF)		5000hrs	-	-	@4.5mW & 25°C

 Note: ^①4.5mW at 25 °C

^②4.5mW at 25 °C

Typical Output Performance

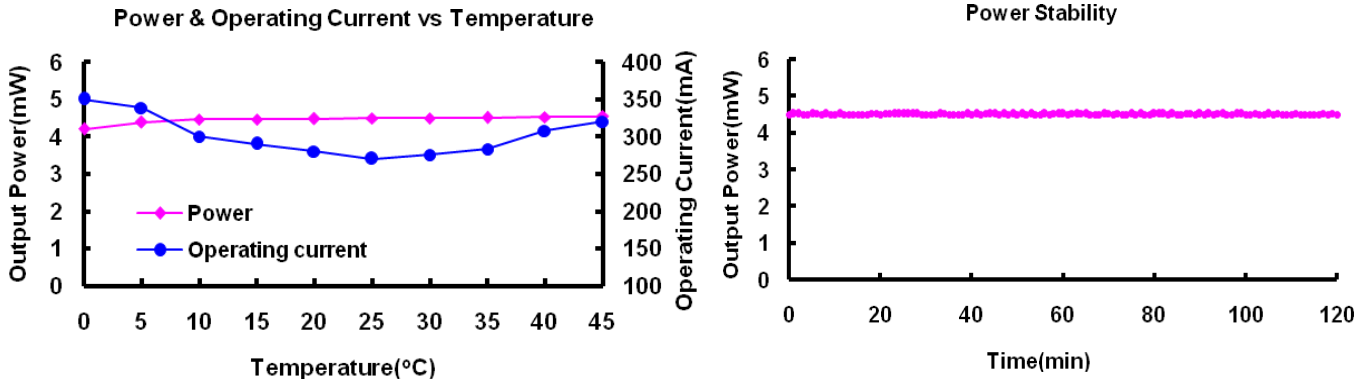

Dimensions and Pin Configuration (Unit: mm)

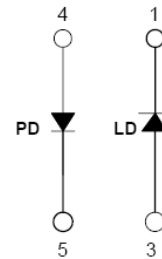
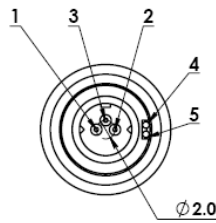
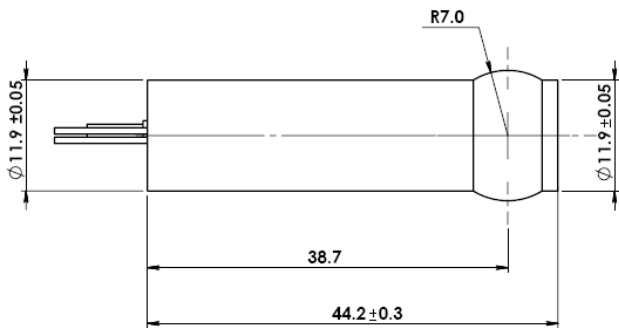

Pin Configurations : 1. LD- 2. None 3. LD+
 4. PD+ 5. PD-